

9.2 MAIN SECTION

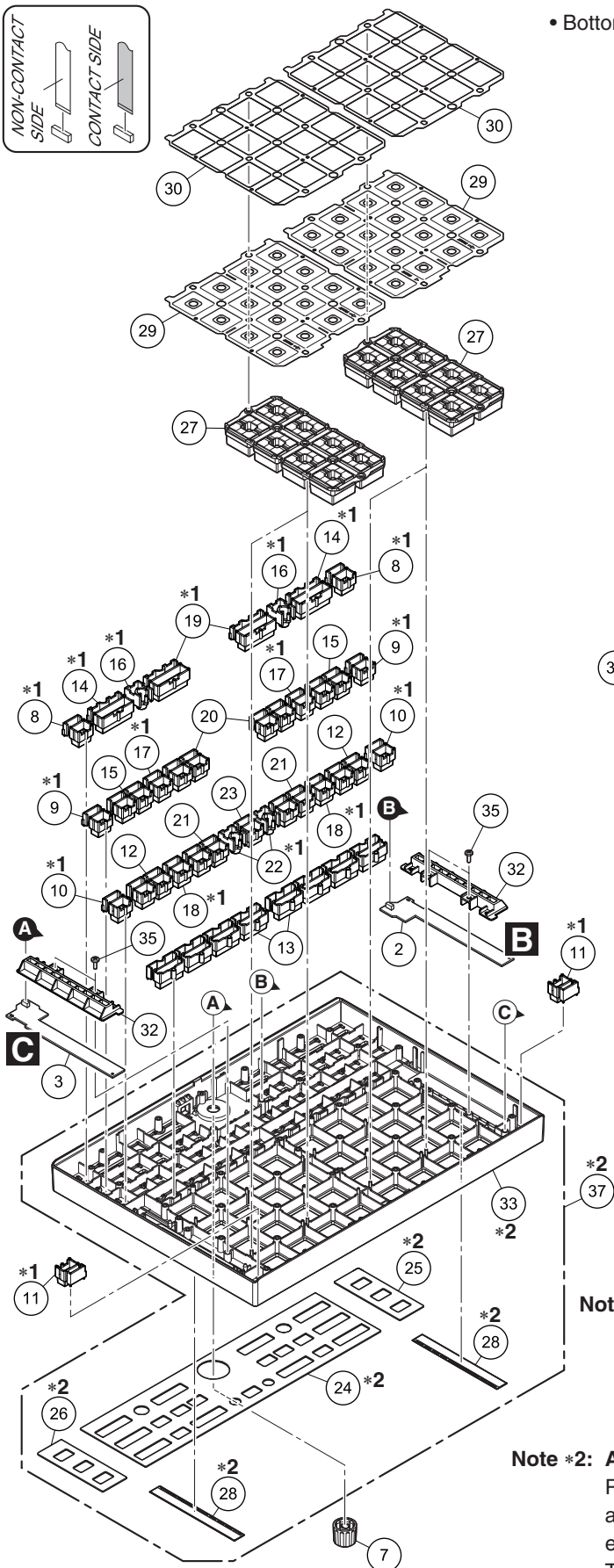

• Bottom view

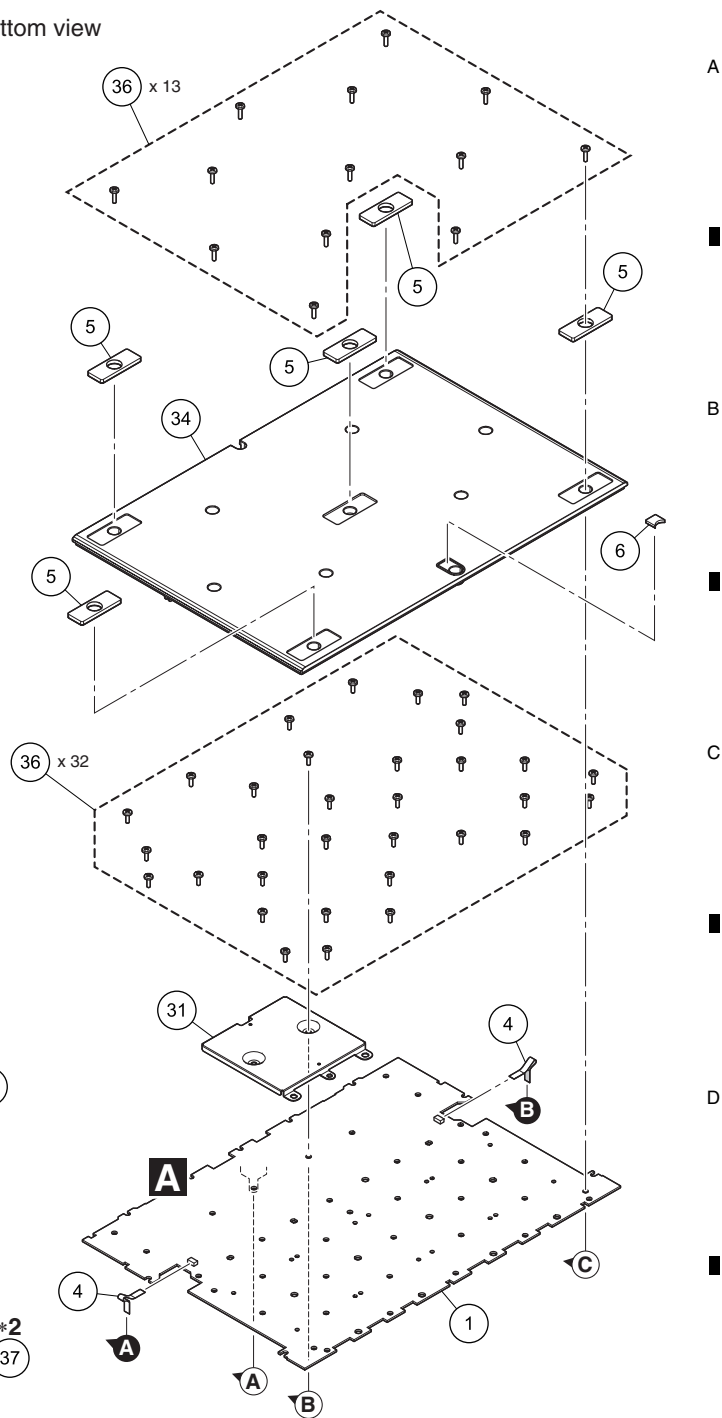

Note *1: Button No. 8, 9, 10, 11, 14, 16, 17, 18, 19 and 22 are supplied in connected pairs. Split each pair before use. Refer to "[1] Buttons Location" of 7. DISASSEMBLY, including the placement of Buttons.

Note *2: About Removal/Attachment of the Panels (Acrylic Panels) Panels (Acrylic Panels: No. 24, 25 and 26) and Sheets No. 28 are adhered to the Control Panel with double-sided tapes over entire surfaces, and are difficult to remove. They must be replaced as a whole unit of the DDJ-XP2 Panel Service ASSY No. 37.

1 2 3 4

(1) MAIN SECTION PARTS LIST

<u>Mark No.</u>	<u>Description</u>	<u>Part No.</u>	<u>Mark No.</u>	<u>Description</u>	<u>Part No.</u>
A	1 MAIN ASSY	DWX4409	21	Button	DAC3342
	2 CDCL ASSY	DWX4130	22	Button	DAC3344
	3 CDCR ASSY	DWX4131	23	Button	DAC3345
	4 FFC	DDD1847	NSP 24	Panel	DAH3294
	5 Foot	DEC3759	NSP 25	Panel	DAH3172
	6 Cushion	DEC3778	NSP 26	Panel	DAH3173
	7 Knob	DAA1384	27	Button	DEB2059
	8 Button	DAC3328	NSP 28	Sheet	DEC3756
	9 Button	DAC3329	29	Sheet	DEC3757
	10 Button	DAC3330	30	Spacer	DEC3758
B	11 Button	DAC3331	31	Plate	DNH3335
	12 Button	DAC3332	32	Holder	DNK6732
	13 Button	DAC3516	NSP 33	Control Panel	DNK6891
	14 Button	DAC3517	34	Chassis	DNK6892
	15 Button	DAC3518	35	Screw	BPZ30P080FNI
	16 Button	DAC3336	36	Screw	BPZ30P120FTB
	17 Button	DAC3521	37	DDJ-XP2 Panel Service ASSY	DEA1093
	18 Button	DAC3338	NSP 38	Name Label	See Contrast table (2)
	19 Button	DAC3339			
C	20 Button	DAC3519			

(2) CONTRAST TABLE

SYXJ and XJCN are constructed the same except for the following:

Mark	No.	Symbol and Description	SYXJ	XJCN
NSP	38	Name Label	Not used	DRW2815

No.34 Chassis (/XJCN) Bottom view

The diagram shows the bottom view of the chassis with a central Pioneer DJ controller. The controller label includes the following text:

Pioneer Dj

DJ CONTROLLER MODEL DDJ-XP2

CONTRÔLEUR POUR DJ / MODELE DDJ-XP2

5 V 775 mA

日本先锋DJ公司

DJ 控制器 型号 DDJ-XP2

马来西亚制造

日本先锋DJ公司设计

DRW2815-A

This device complies with Part 15 of the FCC Rules. Operation is subject to the following two conditions:

(1) This device may not cause harmful interference, and (2) this device must accept any interference received, including interference that may cause undesired operation. (CAN/CSA 02/1004-02)

MADE IN MALAYSIA

FABRIQUE EN MALAISIE

DESIGNED BY PIONEER DJ IN JAPAN

CONÇU PAR PIONEER DJ AU JAPON

SERIAL No.

DNK6892-

DNK689201-A

A red arrow points from the text 'No.38 DRW2815' to a small rectangular area on the controller's label.

34

DDJ-XP2

1 2 3 4