

9.4 CHASSIS SECTION (2/2)

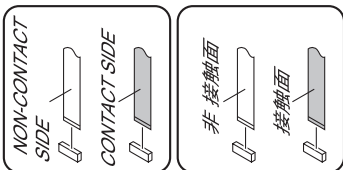
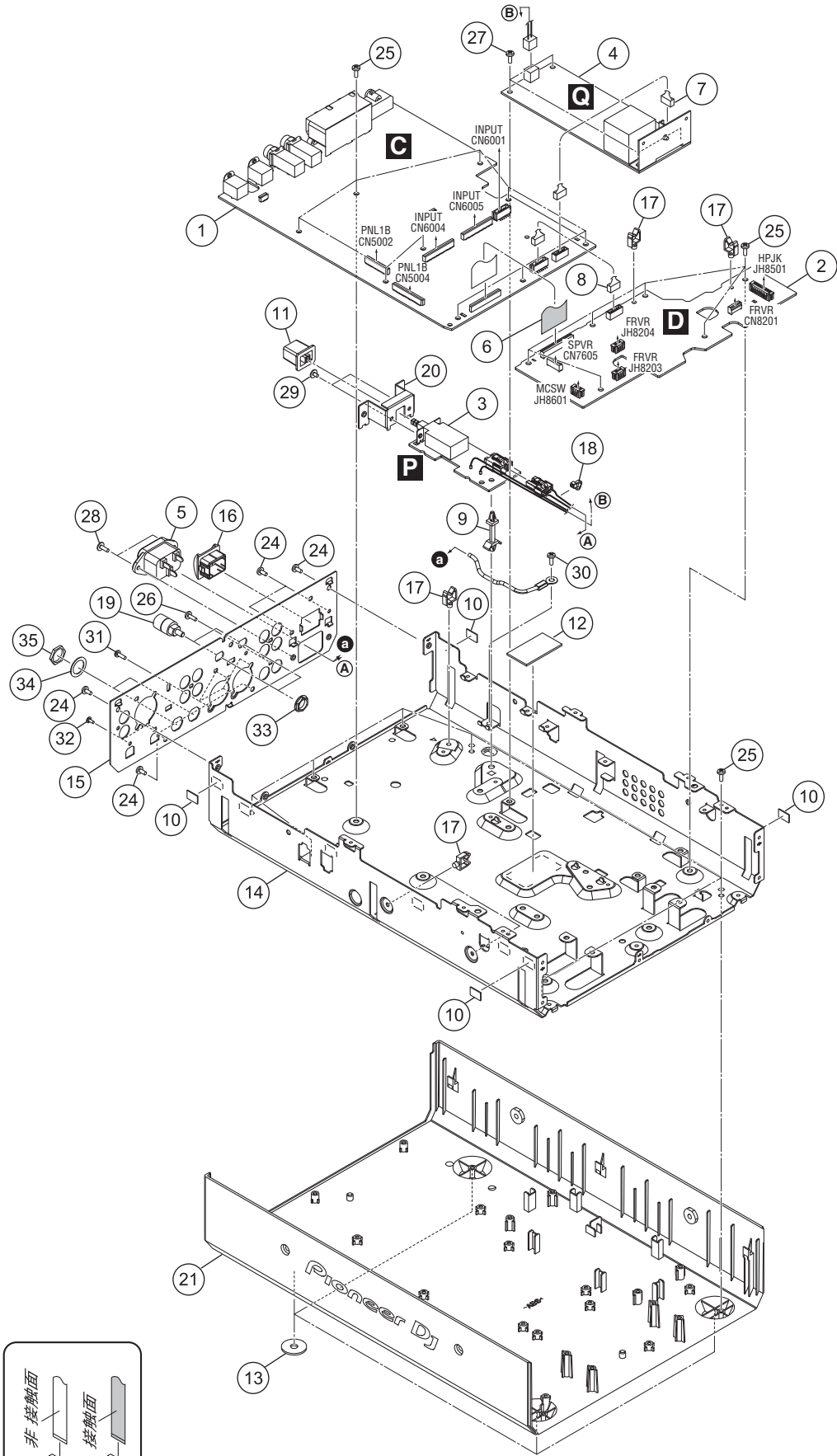

CHASSIS SECTION (2/2) SECTION PARTS LIST

<u>Mark No.</u>	<u>Description</u>	<u>Part No.</u>
A	1 MAIN Assy	DWX3673
	2 HPAMP Assy	DWX3684
	3 ACSW Assy	DWR1547
	⚠ 4 POWER SUPPLY Assy	DWR1463
	⚠ 5 AC Inlet	DKP3973
	6 FFC	DDD1701
	7 Crimp Connector	DDC1023
	8 Connector Assy	PF06PP-D05
NSP	9 PCB Spacer	AEC1446
	10 Cushion 11x7	AED7092
B	11 Power Knob	DAC2306
	12 Heat Cond Sheet	DEB2026
	13 Cushion	DEC3177
NSP	14 Chassis	DNA1456
	15 Rear Panel	DNC2118
	16 Power Knob Guard	DNK4534
	17 Holder	VEC1355
	18 Binder	ZCA-SKB90BK
	19 Earth Terminal	DKE1019
C	20 Bracket PSW	DNF1759
	⚠ 21 Chassis	DNK6442
	22	
	23	
	24 Screw	BBZ30P060FTB
	25 Screw	BPZ30P080FNI
	26 Screw	BPZ30P080FTB
	27 Screw	BPZ30P100FTB
	28 Screw	IBZ30P080FTB
D	29 Screw	IMZ30P040FTC
	30 Screw	PMH40P080FTC
	31 Screw	PPZ30P080FTB
	32 Screw (M3*5)	DBA1340
	33 Flange Nut M9	DBN1008
	34 Washer	DEC2920
	35 Nut (M12)	NKX2FNI

E

F